

NOT FOR CONSTRUCTION

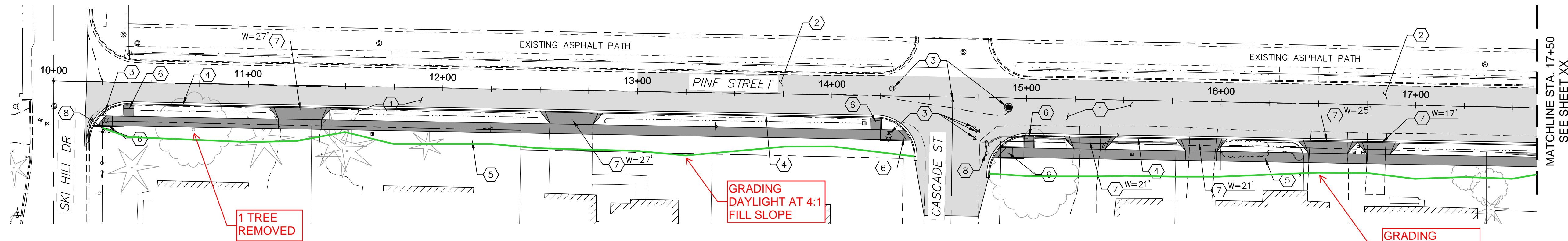

OPTION 2 – ELIMINATION OF PARKING LANE FROM SKI HILL TO CASCADE

GENERAL NOTES

1. PROPOSED SIGNING AND STRIPING PER SHEETS XX THRU XX.
2. PROPOSED STORM DRAINAGE PER SHEETS XX THRU XX.

CONSTRUCTION NOTES

- 1 CONSTRUCT HMA ROADWAY PER SECTIONS ON SHEET 4. ASPHALT SHALL BE WSDOT HMA CL. 1/2 IN. PG 64-28.
- 2 HMA OVERLAY PER SECTIONS ON SHEET 4. ASPHALT SHALL BE WSDOT HMA CL. 1/2 IN. PG 64-28. FINISHED GRADE SHALL BE FLUSH WITH THE LIP OF GUTTER.
- 3 ADJUST EXISTING STRUCTURES (MONUMENTS, WATER VALVES, SANITARY SEWER MANHOLES, ETC) TO FINISHED GRADE AS REQUIRED OR TO NOTED RIM ELEVATION. WATER VALVE ADJUSTMENTS SHALL BE PER CITY OF LEAVENWORTH DETAIL NO. W3, SEE APPENDIX C.
- 4 CEMENT CONC. TRAFFIC CURB AND GUTTER PER WSDOT STD PLAN F-10.12-02.
- 5 5 FOOT WIDE CEMENT CONC. SIDEWALK PER WSDOT STD PLAN F-30.10-03.
- 6 CEMENT CONC. CURB RAMP TYPE SINGLE DIRECTION 'A' PER WSDOT STANDARD PLAN F-40.16-03.
- 7 CEMENT CONC. DRIVEWAY ENTRANCE TYPE 3 PER WSDOT STD PLAN F-80.10-04. WIDTH PER PLAN. SEE STORM DRAINAGE PLANS, SHEET XX THRU XX FOR CULVERT INFORMATION.
- 8 CHELAN COUNTY PUD RELOCATED EXISTING POWER/LIGHT POLE. CONTRACTOR TO VERIFY NEW LOCATION DOES NOT CONFLICT WITH PROPOSED IMPROVEMENTS PRIOR TO CONSTRUCTION.

GRADING DAYLIGHT AT 4:1 FILL SLOPE

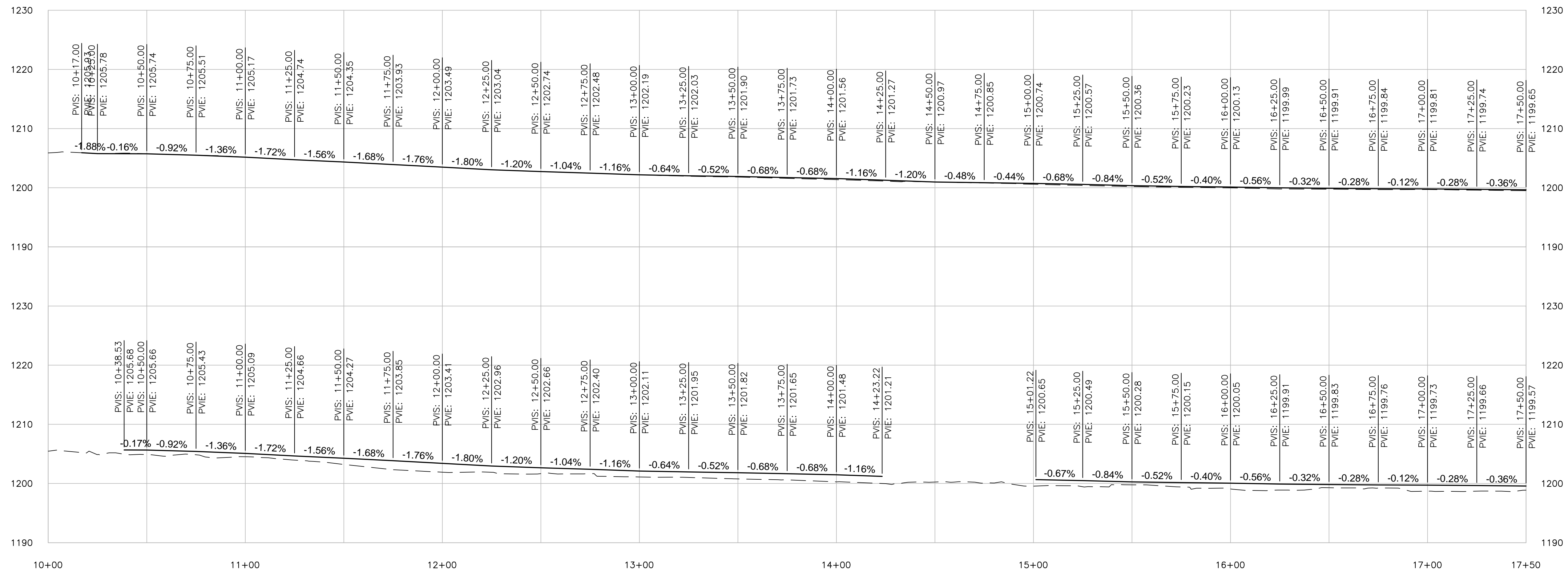
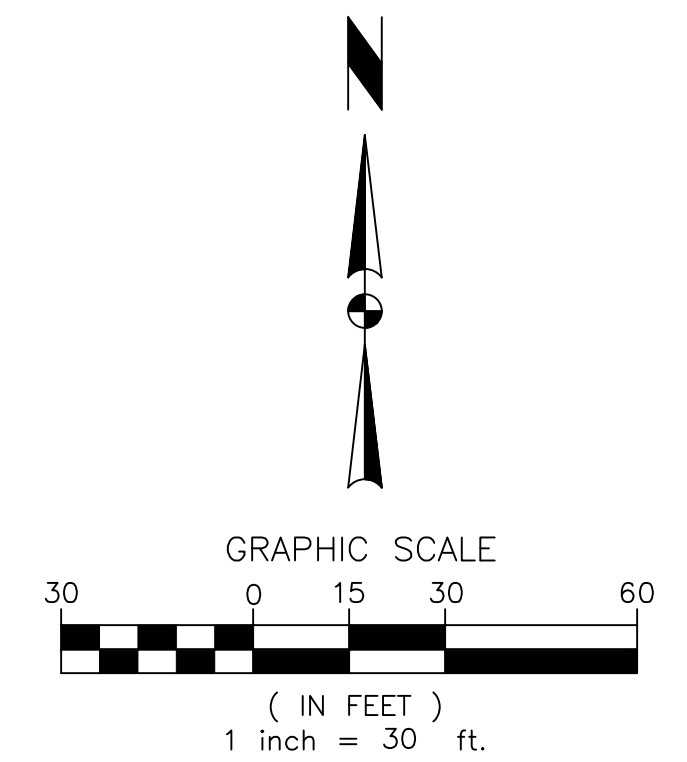

REV	DATE	REVISION

TD&H
Engineering
509.622.2888 • tdhengineering.com

DRAWN BY: JR/DW
DESIGNED BY: DNW
QUALITY CHECK: DNW
DATE: 09/06/17
JOB NO. S17-123
FIELDBOOK

**PINE STREET -PHASE 1: SKI HILL DR. TO TITUS RD.
LEAVENWORTH, WASHINGTON**

**PINE STREET PLAN AND PROFILE
STA. 10+00 TO STA. 17+50**